

# Oneida County Timber Sale Bid Prospectus

**Sale Number/Name: TS-202102 “Rocky Run Road Aspen”**

## **Aspen Sale with Close Mill Proximity and Spring Breakup Ground**

**SALE TYPE: Mill Scale with on-site trip/load ticket box**

**SALE SIZE: 78 Acres**

**CONTRACT PERIOD: 2 Years**

**CONTACT: BCPL Forestry Office: 715-277-3366  
Kevin Burns mobile: 715-360-7438**

**100% FSC Certified Timber**



The mark of  
responsible forestry  
FSC® C120950

**SALE LOCATION: 6 miles southwest of Hazelhurst, Wisconsin**

<u>Town – Range</u>	<u>Section</u>	<u>Quarter-Quarters</u>
T37N-R06E	07	SWSW, SESW, SWSE, SESE, SWNW
T37N-R06E	08	SWNW

### **CUTTING REQUIREMENTS:**

1. Reopen brushed in access road to frozen only stands. 1/8th mile of new winter road construction. Two wet crossings will need to be filled with logs that must be removed after completion of the timber sale. See sale map for details.
2. Cut trees of all species less than 18" DBH.
3. Spring breakup logging (year-round) only allowed in T37N-R06E Section 8 (28 acres).
4. Frozen only logging (Dec 1 - April 1) in all areas of T37N-R06E Section 7 (50 acres).
5. Cutting boundaries are set by roads, blue property lines or red cutting lines.

### **TIMBER VOLUME ESTIMATE AND MINIMUM BID VALUES:**

<u>Species &amp; Products</u>	<u>Estimated Volume</u>	<u>Minimum Bid</u>
Aspen / Bolts	500 cords	\$ 35.00
Aspen / Pulp	3,060 tons	\$ 10.00
Mixed Softwood / Pulp	740 tons	\$ 5.00
Mixed Pine / Bolts	45 cords	\$ 30.00
Mixed Pine / Pulp	35 tons	\$ 10.00
Hardwood / Pulp	12 tons	\$ 8.00

**MINIMUM ACCEPTABLE BID:**  
\$53,596.00

**AVERAGE VOLUME PER ACRE ESTIMATE**  
22.1 Cords/Acre

**SALE OBJECTIVES:** Create a clean coppice with standards to regenerate a dense aspen stand with a pine component.

**ACCESS & TERRAIN:** Direct woods road access from Cty Hwy Y immediately west of the intersection of Rocky Run Rd and Cty Hwy Y. An extensive woods road network ensures short skidding distances. Terrain is gently rolling sandy ground with some low wet flats.

### **OTHER SALE REQUIREMENTS AND CONDITIONS:**

- **The BCPL can restrict the type of equipment used on the job if conditions or damage warrant.**
- **Logging operations may be suspended if excessive rutting is occurring.**
- **BMP's (see Field Manual PUB-FR-093-2010) are mandatory for this sale.**
- **Notify the BCPL (715-277-3366) before you start the job.**
- **No decking on Rocky Run Rd; BCPL woods road will be used for decking.**

# Timber Sale Bid



Date \_\_\_\_\_

I herewith submit the following bid for timber described below. I also understand that if I am awarded the contract and fail to sign it, I may be barred from bidding on future BCPL timber sales.

Completion of this form is mandatory. The BCPL will not recognize your bid unless you complete and submit this form. Personal information on this form will not be used for any other purpose.

<b>Common Name:</b> Rocky Run Road Aspen				<b>Timber Sale Number</b>
<b>Date and Hour of Bid Opening:</b> July 2, 2021 10:01AM				<b>TS-202102</b>
Species / Product	Estimated Volume	Minimum Bid Per Volume Unit	Bid Per Volume Unit	Total Bid Value on Estimated Volume
Aspen, Tremblin / Pulp	3,060.00 TONS	\$10.00		
Aspen, Tremblin / Bolts	500.00 CORD	\$35.00		
Misc Softwood / Pulp	740.00 TONS	\$5.00		
Pine, mixed / Bolts	45.00 CORD	\$30.00		
Pine, mixed / Pulp	35.00 TONS	\$10.00		
Misc Hardwood / Pulp	12.00 TONS	\$8.00		
The award shall be based on this TOTAL BID AMOUNT:				\$

**DO NOT SEND ANY FUNDS (DEPOSIT), with the bid form.**  
**A 25% deposit is only required from the highest (winning) bidder at the time of contract signing.**

**25 % Performance Bond WILL BE (circle one):**

Check                      Certified Check/Money Order                      Letter of Credit                      Assurance Bond

I understand that any or all bids may be rejected and that consideration and awarding of a contract will be based upon my past performance and ability to complete contracts.

A copy of the standard timber sales contract, which must be entered into, is available upon request from the BCPL. All bids including Lump Sum bids must be by Species and Product.

Bidder's Signature: \_\_\_\_\_ Street or Route \_\_\_\_\_

Bidder's Name: \_\_\_\_\_ City, State, Zip \_\_\_\_\_

Office/Home Phone # (\_\_\_\_\_) \_\_\_\_\_ Cell Phone # (\_\_\_\_\_) \_\_\_\_\_

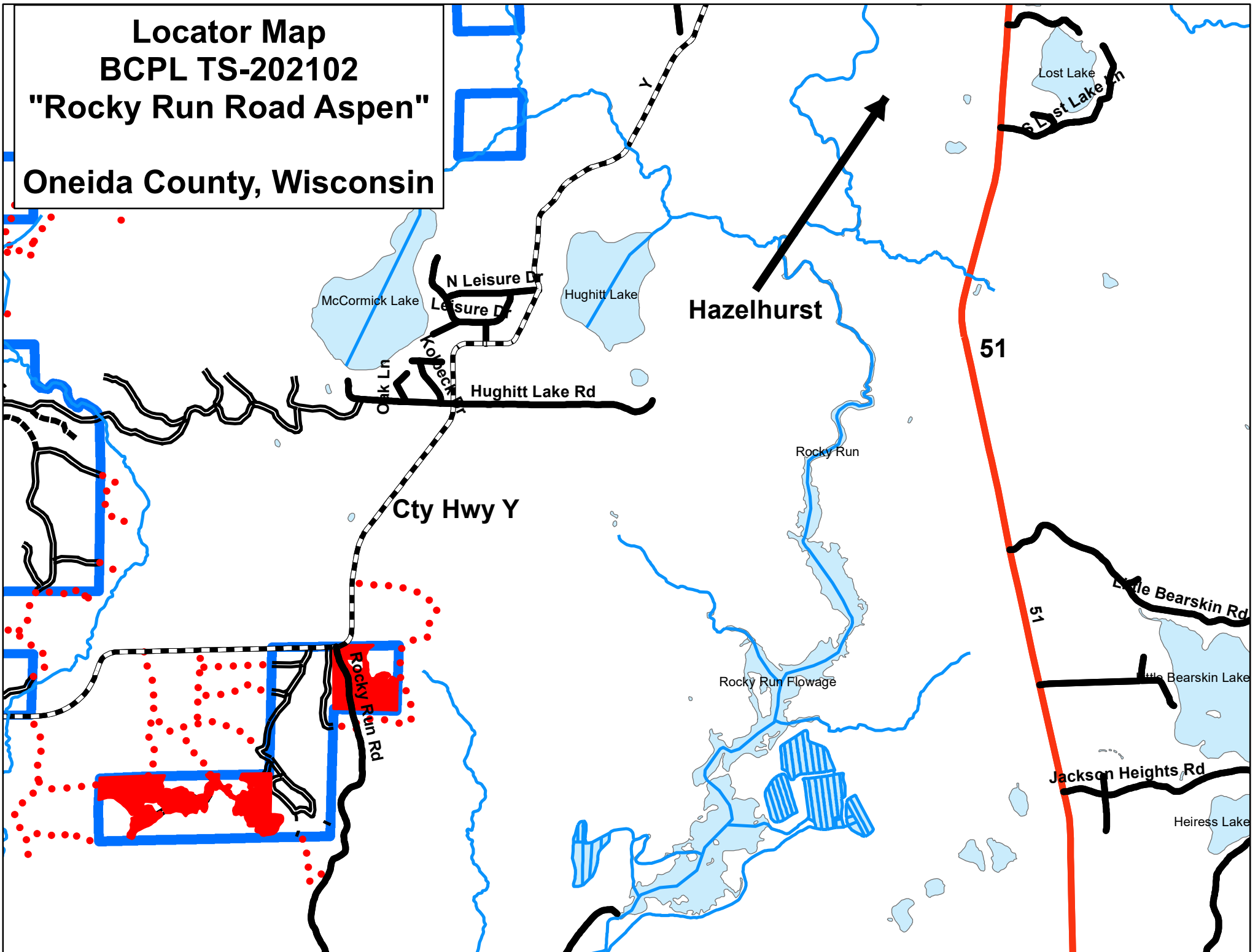

E-Mail: \_\_\_\_\_

**Locator Map**  
**BCPL TS-202102**  
**"Rocky Run Road Aspen"**  
**Oneida County, Wisconsin**





# TS-202102 "Rocky Run Road Aspen"

## Harvest Prescription

-  Frozen Only Harvest - Clearcut (50 acres)  
Cut trees of all species less than 18" DBH.
-  Year-Round Harvest - Clearcut (28 acres)  
Cut trees of all species less than 18" DBH.
-  Non-Harvest Stands

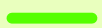
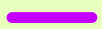
## Work Required

-  Brush/Dozer Existing Road
-  New Road Construction
-  Wet Crossing - Fill with logs, must be removed at end of sale.

