



**TS-201702
Oneida County**

SALE NAME: Woodboro SE

THIS IS A Ticket SALE

SALE LOCATION

Oneida County, Township of: Woodboro
Section: 13, 18 Town: 36N Range: 6E
Sale Size: 93 Acres

CONTRACT PERIOD: 3 Years

Contacts: John Schwarzmann, 715-277-3366 (o)
715-892-0662 (c)
Keb Guralski, 715-277-3366 (o)

Timber sold under this contract is certified. FSC® 100%:



<u>Town and Range</u>	<u>Section</u>	<u>Legal Descriptions</u>
T36N-R6E	13	<u>Quarter-Quarters</u> NESE, NWSE, SWSW, SESE
T36N-R7E	18	SWSW

Cutting Requirements

- 1) Cut all aspen, red and sugar maple, and white birch with one or more sticks.
- 2) Cut all trees marked in orange paint.
- 3) Do not cut any trees marked in teal paint, they are leave trees.
- 4) Do not cut any trees marked in red paint, they are line trees.
- 5) Cutting boundaries are marked in red or blue paint lines.
- 6) Logging will be allowed from July 15 to October 15th in dry conditions or in the winter from Dec. 1 to March 15th.

Timber Volume Estimates & Minimum Bid Values

<u>Pulpwood(Cords)</u>	<u>Estimated Volume</u>	<u>Minimum Bid</u>
Hardwood	1040 Cords	\$35.00/Cord
Aspen	820 Cords	\$35.00/Cord
White Birch	160 Cords	\$35.00/Cord
Mixed Pine	10 Cords	\$10.00/Cord

<u>Sawtimber(MBF)</u>	<u>Estimated Volume</u>	<u>Minimum Bid</u>
Red maple	20 MBF	\$150.00/MBF
White Pine	6 MBF	\$100.00/MBF

ADVERTISED VALUE / MINIMUM ACCEPTABLE BID: \$74,400

SALE OBJECTIVES: The harvest objective is thin out the oak and white pine stands and to regenerate the mixed red maple/aspen stands back to an even-aged aspen/red maple stand. Some trees were marked in teal paint to retain for wildlife habitat and to prevent epicormic sprouting on high-quality red oak crop trees.

Access - Direct town road access from the Oscar Jenny Lake road to the main Woodboro Wildlife Area rd.. High quality, Unrutted, woods roads bisect the property ensuring very short skidding distances.

OTHER SALE REQUIREMENTS AND CONDITIONS:

- The BCPL can restrict the type of equipment used on the job if conditions or damage warrant.
- Weight/volume conversion factors are listed in the general timber sales conditions and are identical to those listed as in the Wisconsin DNR Timber Sale Handbook
- BMP's (see Field Manual PUB-FR-093-2010) are mandatory for this sale.
- Notify the BCPL (715-277-3366) before you start the job.

Timber Sale Bid



Date _____

I herewith submit the following bid for timber described below. I also understand that if I am awarded the contract and fail to sign it, I may be barred from bidding on future BCPL timber sales.

Completion of this form is mandatory. The BCPL will not recognize your bid unless you complete and submit this form. Personal information on this form will not be used for any other purpose.

Common Name (If any): Woodboro SE – Ticket Timber Sale				Timber Sale Number
Date and Hour of Bid Opening: May 19, 2016 10:01AM				TS-201702
Species	Estimated Volume	Min. Required Bid Per Volume Unit	Price Bid Per Volume Unit	Total Bid Value on Estimated Volume
Aspen	820 Cords	\$35.00		
Hardwood	1,040 Cords	\$35.00		
Mixed pine	10 Cords	\$15.00		
White birch	160 Cords	\$35.00		
Red maple	20 MBF	\$150.00		
White pine	6 MBF	\$100.00		
The award shall be based on this TOTAL BID AMOUNT:				\$

DO NOT SEND ANY FUNDS (DEPOSIT), with the bid form.
A 25% deposit is only required from the highest (winning) bidder.

25 % Sale Down Payment (DEPOSIT) WILL BE (check one):

- Check
- Certified Check/Money Order
- Letter of Credit

10 % Performance Bond WILL BE (check one):

- Check
- Certified Check/Money Order
- Letter of Credit
- Assurance

I understand that any or all bids may be rejected and that consideration and awarding of a contract will be based upon my past performance and ability to complete contracts.

A copy of the standard timber sales contract, which must be entered into, is available upon request from the BCPL.

All bids including Lump Sum bids must be by species.

Bidder's Signature: _____ Street or Route _____

Bidder's Name: _____ City, State, Zip _____

Office/Home Phone # (_____) _____ Cell Phone # (_____) _____

Timber Sale Bid



Date _____

I herewith submit the following bid for timber described below. I also understand that if I am awarded the contract and fail to sign it, I may be barred from bidding on future BCPL timber sales.

Completion of this form is mandatory. The BCPL will not recognize your bid unless you complete and submit this form. Personal information on this form will not be used for any other purpose.

Common Name (If any): Woodboro SE			Timber Sale Number	
Date and Hour of Bid Opening: May 19, 2016 10:01AM			TS-201702	
Species	Estimated Volume	Min. Required Bid Per Volume Unit	Price Bid Per Volume Unit	Total Bid Value on Estimated Volume

**TS-201702 - Oneida County - Woodboro SE Timber Sale
 Locator Map**

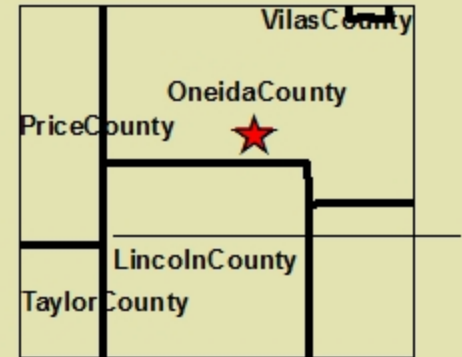
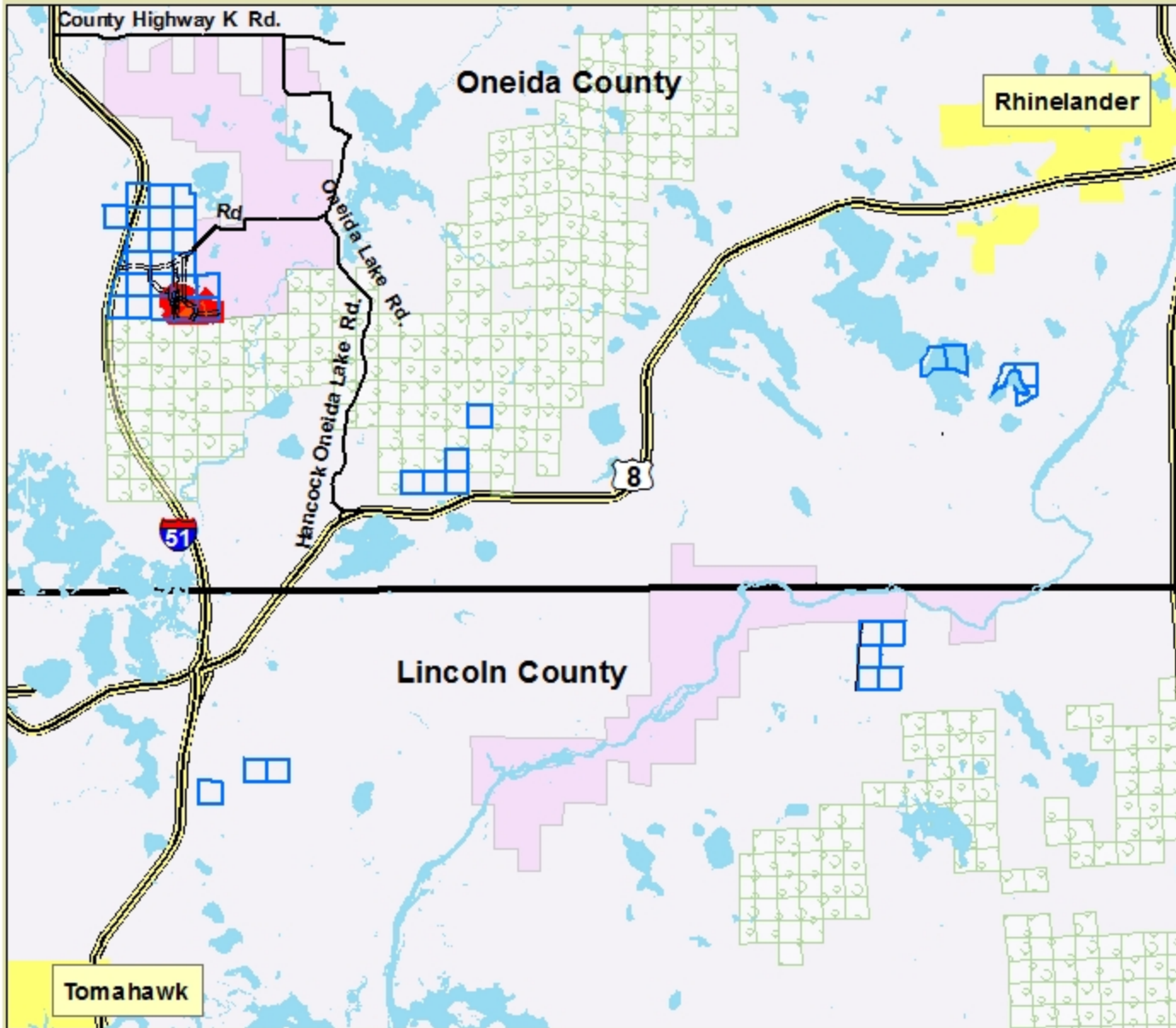

Scale 1:115,000
Township: Woodboro
Acres: 93

Legend

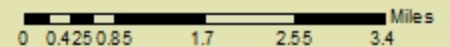
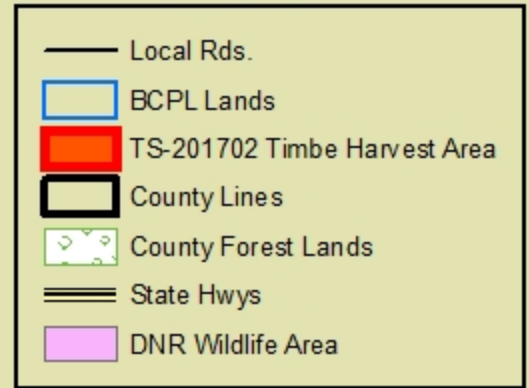

TS-201702 - Oneida County - Woodboro SE Timber Sale
T36N-R6E Section 13 - SE1/4
T36N-R7E Section 18 - SWSW

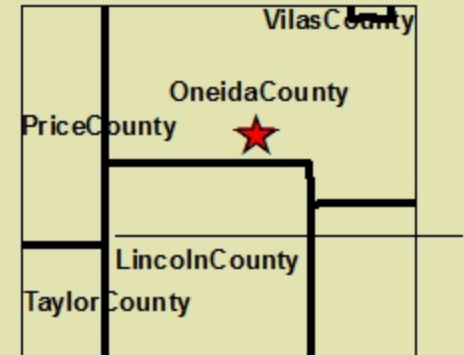
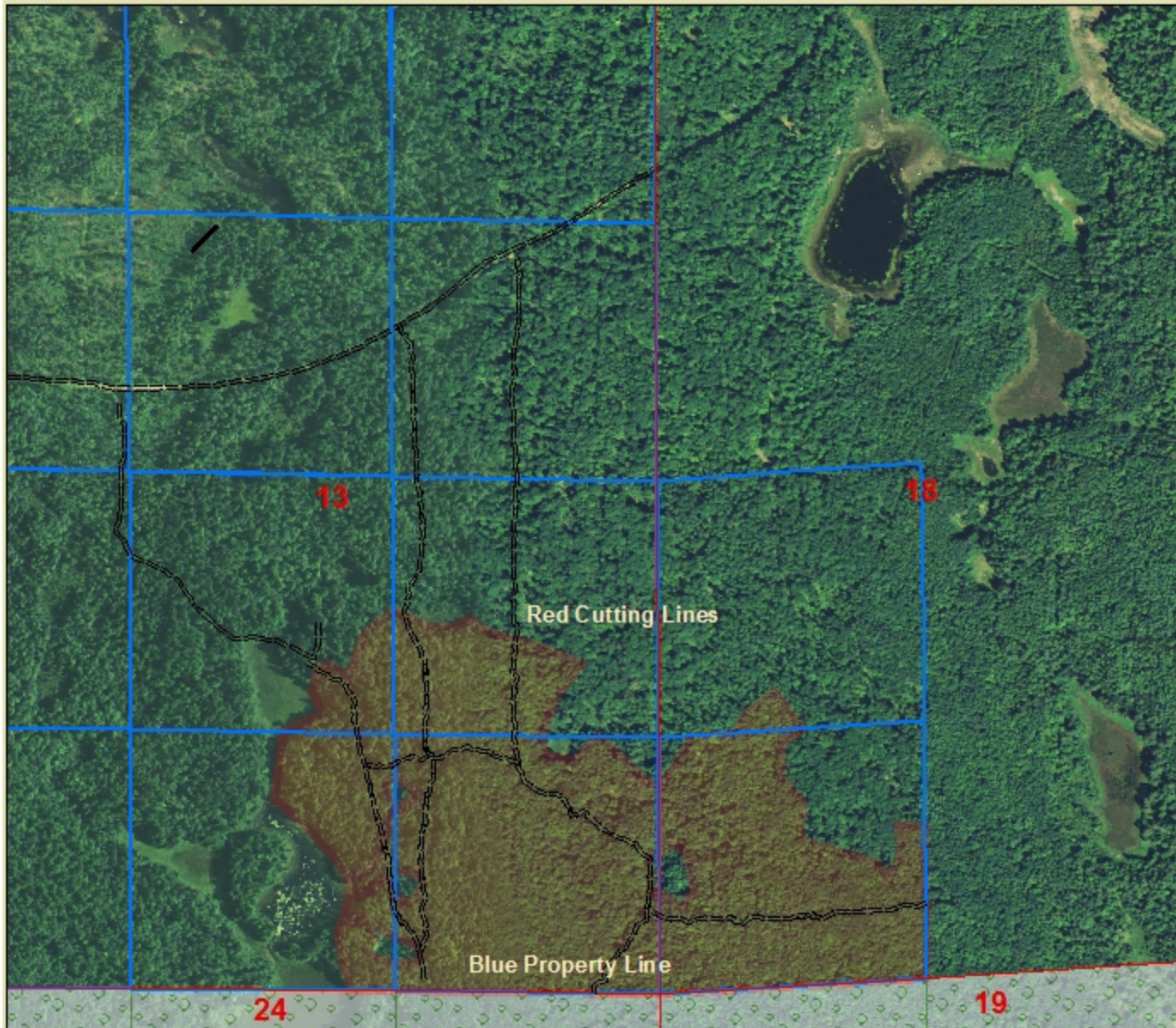

Scale 1:10,000

Township: Woodboro

Acres: 93

Legend

