



TS-202009
Chippewa County
Summer Logging Opportunity

SALE NAME: Withrow Lake

Sale Type -Ticket (Mill scale) for Pulp & Bolts & Logs

SALE LOCATION

Chippewa County, Township of: Colburn
 Section: 22 Town: 30N Range: 5W
 Sale Size: 30 Acres

CONTRACT PERIOD: 3 Years

**Contacts: John Schwarzmann, 715-277-3366 715-892-0662 (c)
 Kevin Burns 715-360-7438 (c)**

Legal Descriptions

<u>Town and Range</u>	<u>Section</u>	<u>Quarter-Quarters</u>
T30N-R5W	22	NESE

Cutting Requirements

- 1) Cut all trees marked with orange paint.
- 2) Oak Wilt cutting restrictions in effect: Logging allowed between July 15th and Oct 15th and from Dec. 1 to April 1.

Timber Volume Estimates & Minimum Bid Values

<u>Pulpwood & Bolts (Tons)</u>	<u>Estimated Volume</u>	<u>Minimum Bid</u>
Basswood	40 Tons	\$2.50/Ton
Mixed Hardwood	600 Tons	\$9.00/Ton
Oak	60 Tons	\$10.00/Ton
<u>Sawtimber (MBF)</u>	<u>Estimated Volume</u>	<u>Minimum Bid</u>
Basswood	1 MBF	\$200.00/MBF
Red Maple	9 MBF	\$200.00/MBF
Sugar Maple	5 MBF	\$350.00/MBF
Red Oak	26 MBF	\$350.00/MBF
Black Ash	1MBF	\$180.00/MBF
White Ash	10 MBF	\$200.00/MBF

**ADVERTISED VALUE / MINIMUM ACCEPTABLE BID: \$21,130 Volume per acre: 13.3 Cord Equiv./acre
 32.4 Tons/acre**

SALE OBJECTIVES: The harvest objective is to promote oak retention on the site by removing suppressed maples and thinning out red oak groves to give a crown release to existing crop trees. Single-tree selection is used to release crop trees and to limit the area in large gaps which can convert in to berry bushes. Marking removed mostly suppressed, poor- quality trees, with some prime veneer and mature sawlogs. Maple quality can vary. Red oak log quality is good with a high proportion of grade 1 logs, some veneer with most of the rest in grade 2.

Access & Terrain- The site can be reached by coming from Hwy 150th Avenue and going east on a graveled road about 500 feet to a woods road on land owned by Bill Brodacki. (See map) A road crossing over the wetland will need to be reconstructed using fill from the side of the hill. A new 24' x 14" culvert will need to be installed in the crossing to prevent flooding above the fill site. Terrain is rolling hills with several steep slopes. Soils are mostly sandy loams with some pockets of silt loam and some wet swales. The wood will need to be forwarded to a landing (See Close Up map) about 500 feet south of the SW corner of the timber sale area because there are no internal roads on the BCPL property. Forwarding distances will vary from as little as 500 feet to as much as 2,200 feet and average about ¼ mile.

OTHER SALE REQUIREMENTS AND CONDITIONS:

- The BCPL can restrict the type of equipment used on the job if conditions or damage warrant.
- BMP's (see Field Manual PUB-FR-093-2010) are mandatory for this sale.
- Notify the BCPL (715-277-3366) before you start the job.
- Sawlog volume estimates are from a 100% tally. Hwd pulp is estimated at 2.5 tons/cd.

TS-202009 - Chippewa County - Withrow Lake Timber Sale Locator Map

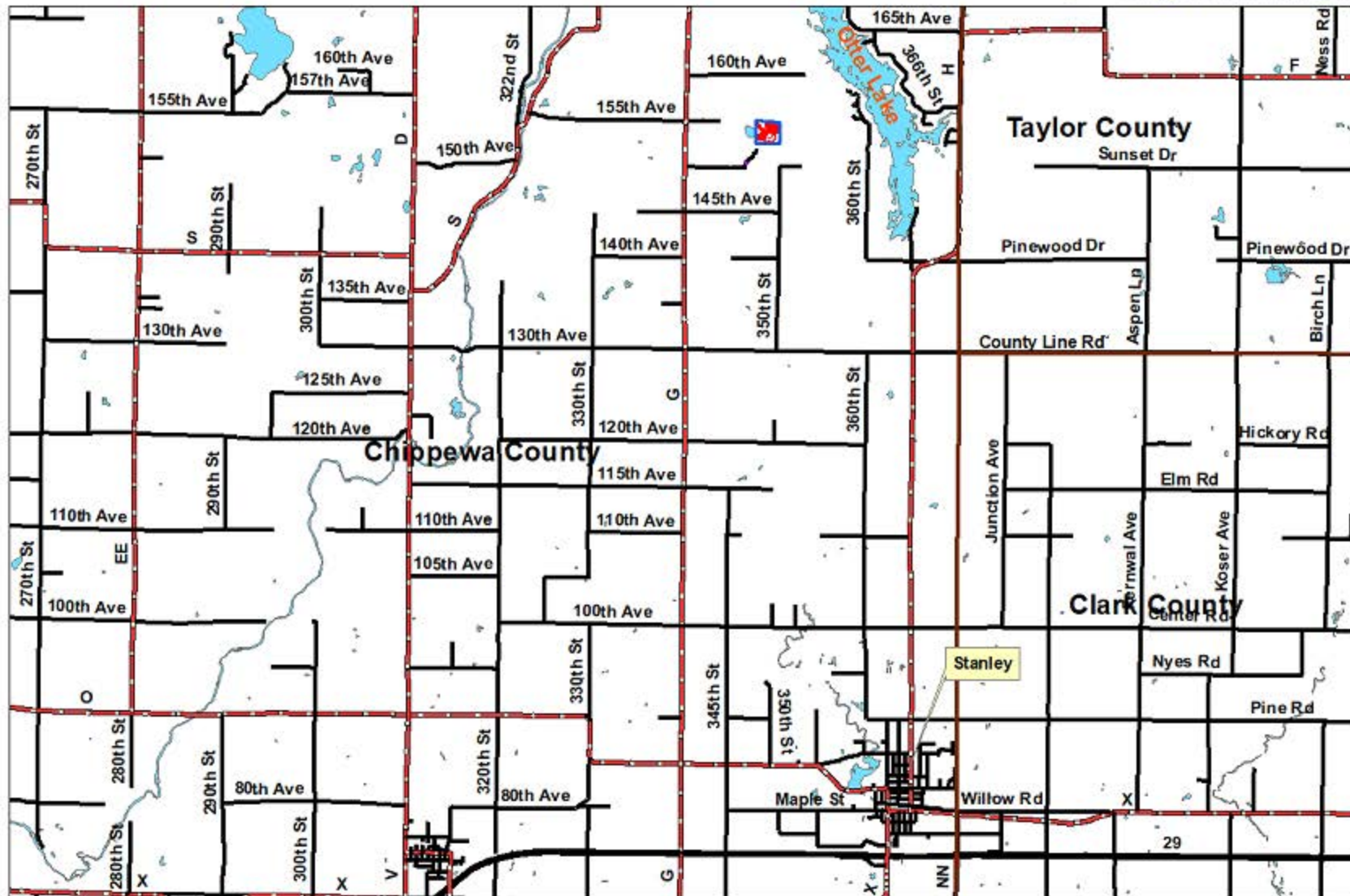

Legend

- BCPL Lands
- TS-202009
- Property Corners
- Local Road
- State On/Off Ramp
- Interstate Highway
- US Highway
- US Connecting Highway
- State Trunk
- State Connecting Highway
- State Connector
- County Trunk Highway
- Lakes

Scale: 1:70,000

- Cutting Requirements**
1. Cut all trees marked in orange paint.
 - 2.. Property Boundary in Blue

Cutting Area: 30 Acres



**TS-202009 - Chippewa County
Withrow Lake Timber Sale
T30N-R5W Section 22, NESE**

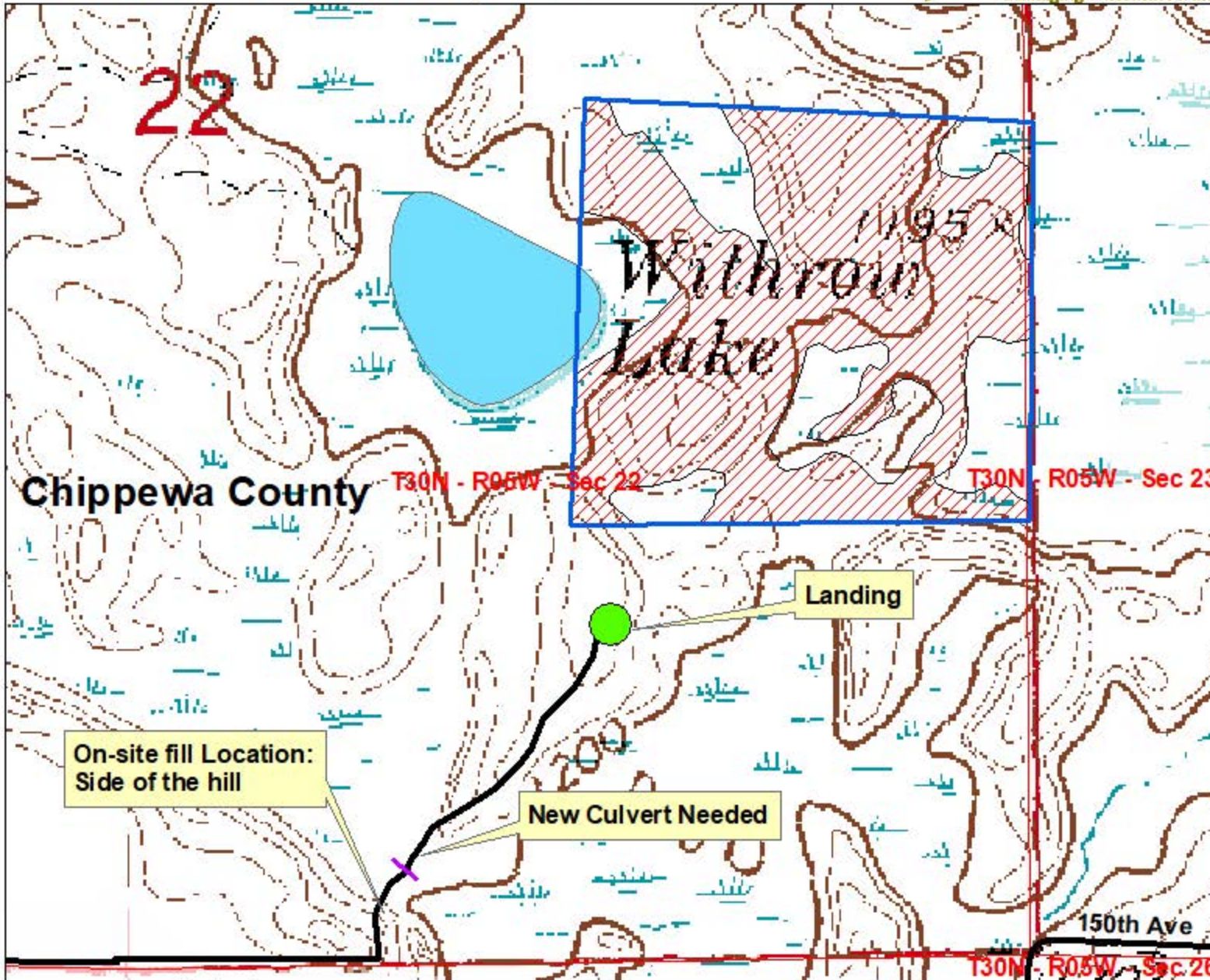

Legend

- BCPL Lands
- TS-202009
- Property Corners
- Local Road
- State On/Off Ramp
- Interstate Highway
- US Highway
- US Connecting Highway
- State Trunk
- State Connecting Highway
- State Connector
- County Trunk Highway
- Lakes
- Sections

Scale: 1:5,500

- Cutting Requirements**
1. Cut all trees marked in orange paint.
 2. Property Boundary in Blue

Cutting Area: 30 Acres

