



**TS-201703
Vilas County**

SALE NAME: West Clear Lake Timber Sale

THIS IS A Scaled Sale

SALE LOCATION

Vilas County, Township of: Lac du Flambeau
Section: 34 Town: 40N Range: 4E
Sale Size: 50 Acres

CONTRACT PERIOD: 3 Years

**Contacts: John Schwarzmann, 715-277-3366 (o)
715-892-0662 (c)
Keb Guralski, 715-277-3366 (o)**

Legal Descriptions

<u>Town and Range</u>	<u>Section</u>	<u>Quarter-Quarters</u>
T40N-R4E	34	NESE, NWSE

Cutting Requirements

- 1) Cut all trees marked in orange paint.
- 2) Cutting lines are marked with blue property boundaries, or swamp edges.
- 4) Logging will be allowed from Dec.1 to March 30th or July 15th to Oct 15th under dry or frozen conditions

Timber Volume Estimates & Minimum Bid Values

<u>Pulpwood(Cords)</u>	<u>Estimated Volume</u>	<u>Minimum Bid</u>
Hardwood	200 Cords	\$30.00/Cord

<u>Sawtimber(MBF)</u>	<u>Estimated Volume</u>	<u>Minimum Bid</u>
Red Maple	14 MBF	\$180.00/MBF
Sugar Maple	48 MBF	\$400.00/MBF
Misc. Hwd.	1 MBF	\$200.00/MBF

ADVERTISED VALUE / MINIMUM ACCEPTABLE BID: \$27,920 Volume per acre: 7.0 Cords/acre

SALE OBJECTIVES: The harvest objective is to remove the overstory as the second cut of a two-cut shelterwood to convert the stand to red oak. Be careful to run over as little regeneration as possible during all logging operations. Almost all of the logs are small and medium sized logs between 12 and 18 inches in DBH. The pulpwood also has a significant fraction of bolts. Quality in the red maple is very good with an estimate of 8-10% veneer.

Access & Terrain- Direct woods road access from West Clear Lake Road. An extensive woods road network ensures short skidding distances. Terrain is flat or rolling hills with just a few rocks and wet pockets. Soils are sandy loam and should drain quickly after rain.

OTHER SALE REQUIREMENTS AND CONDITIONS:

- The BCPL can restrict the type of equipment used on the job if conditions or damage warrant.
- BMP's (see Field Manual PUB-FR-093-2010) are mandatory for this sale.
- Notify the BCPL (715-277-3366) before you start the job.

TS-201703 Vilas County - Locator Map

West Clear Lake Timber sale

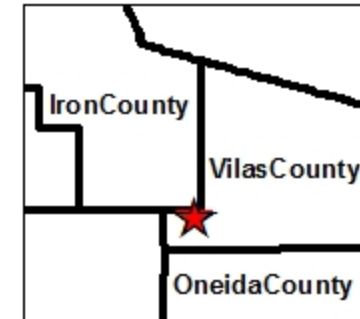
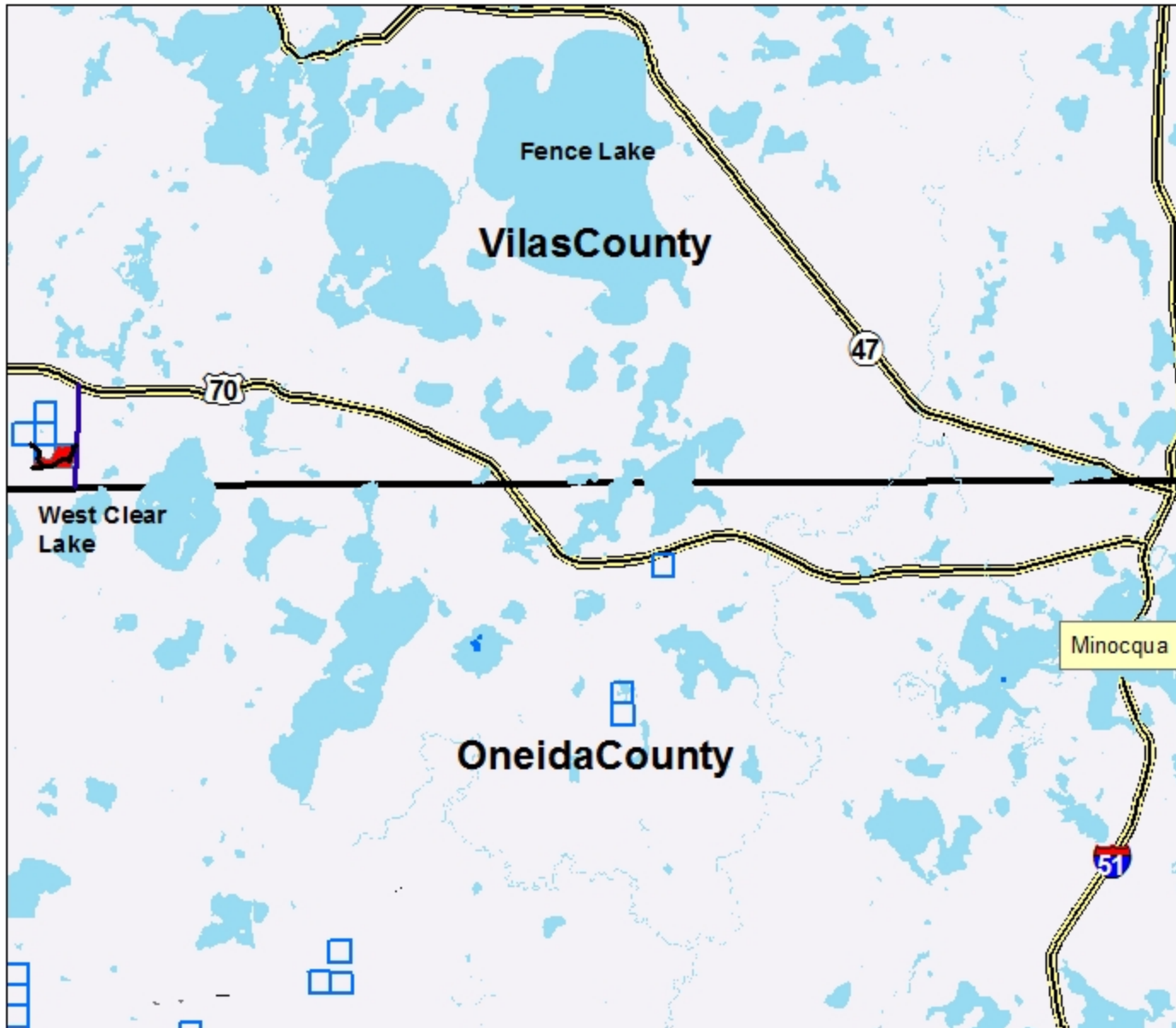

Scale 1:120,000

Township: Lac Du Flambeau

Cutting Area : 50 Acres

Legend

- Town Rds.
- TS-201703 Cutting Area
- BCPL Tracts
- Lakes
- County Lines
- State Hwys

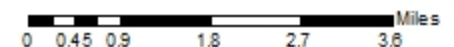

TS-201703 - Vilas County - Close Up West Clear Lake Timber Sale T40N - R4E - Section 34, NESE, NWSE

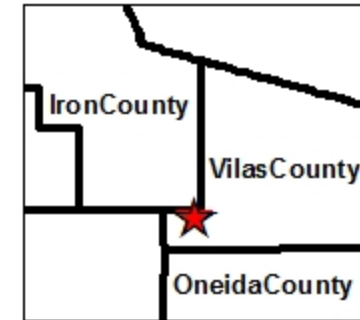
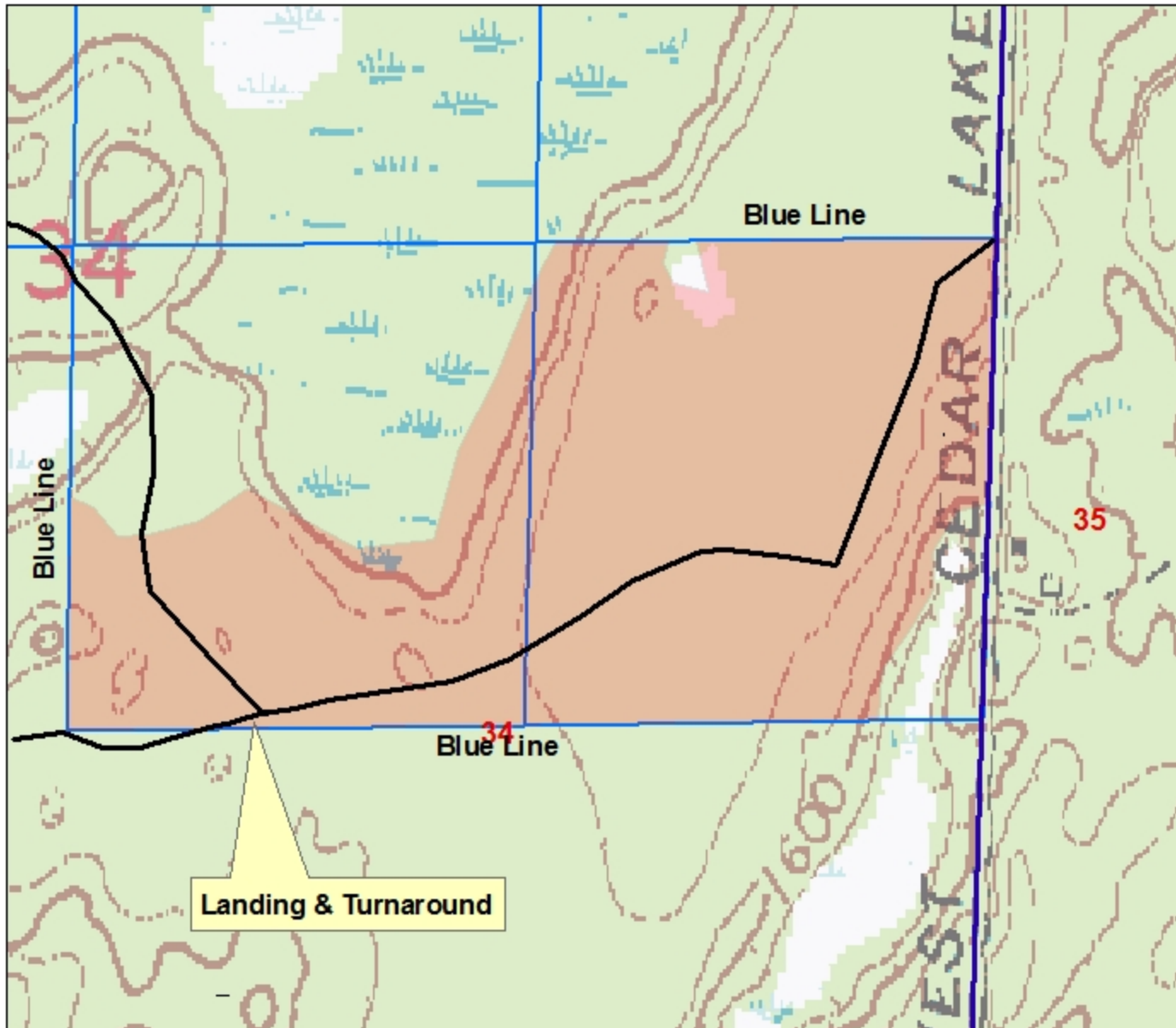

Scale 1:5,000
Township: Lac Du Flambeau
Cutting Area : 50 Acres

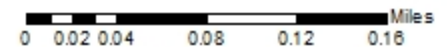
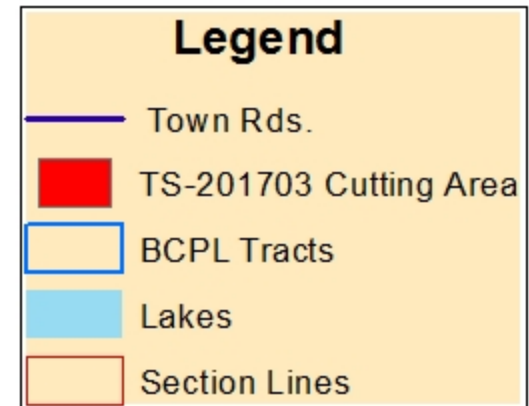

Timber Sale Bid



Date _____

I herewith submit the following bid for timber described below. I also understand that if I am awarded the contract and fail to sign it, I may be barred from bidding on future BCPL timber sales.

Completion of this form is mandatory. The BCPL will not recognize your bid unless you complete and submit this form. Personal information on this form will not be used for any other purpose.

Common Name (If any): West Clear Lake			Timber Sale Number	
Date and Hour of Bid Opening: April 6, 2017 10:01AM			TS-201703	
Species	Estimated Volume	Min. Required Bid Per Volume Unit	Price Bid Per Volume Unit	Total Bid Value on Estimated Volume
Hardwood	200 Cords	\$30.00		
Misc hardwood	1 MBF	\$200.00		
Red maple	14 MBF	\$180.00		
Sugar maple	48 MBF	\$400.00		
The award shall be based on this TOTAL BID AMOUNT:				\$

DO NOT SEND ANY FUNDS (DEPOSIT), with the bid form.

A 25% deposit is only required from the highest (winning) bidder.

25 % Sale Down Payment (DEPOSIT) WILL BE (check one):

Check Certified Check/Money Order Letter of Credit

10 % Performance Bond WILL BE (check one):

Check Certified Check/Money Order Letter of Credit Assurance Bond

I understand that any or all bids may be rejected and that consideration and awarding of a contract will be based upon my past performance and ability to complete contracts.

A copy of the standard timber sales contract, which must be entered into, is available upon request from the BCPL.

All bids including Lump Sum bids must be by species.

Bidder's Signature: _____

Street or Route _____

Bidder's Name: _____

City, State, Zip _____

Office/Home Phone # (_____) _____

Cell Phone # (_____) _____